

Stylized Chickadee

Design by Casey Koller, Fabrication by Mark Waterbury, Text by Maureen James



These two suncatcher patterns were designed by Casey Koller. Casey passed away in 2005 at the age of eighty-seven. He learned the craft of glass at night while working days in a cabinet shop. Koller retired from woodworking after thirty-five years and began his career in glass at the age of fifty. He truly enjoyed designing for and working with glass and wanted to share these patterns with other stained glass enthusiasts.

Early in his career in the 1980s, pattern books were limited, so Casey began designing his own patterns and sold thousands of his finished pieces in various shops and catalogs, including the National Audubon Society Gift Shop and Catalog. He also designed and fabricated the windows in the United Methodist Church in Oxford, Connecticut, and the Emanuel Lutheran Church in North Grosvenordale, Connecticut, as well as cabinet doors and windows for private residents.

Birds were one his favorite subjects and the chickadee was one of his best sellers. We hope you enjoy his patterns and build projects in his memory that give you pleasure for a lifetime.

GPO

Paul Wissmach Glass Co.

All pieces cut from scrap glass

#502, Opal Swirled with Medium Gray/Brown for Wings and Tail

#51-DDXXM, Opal Swirled with Crystal for Face and Neck

#58-D, Medium Amber/Opal/Crystal for Breast

#57-D, Medium Green/Opal/Crystal for Leaves

#2-D, Yellow/Opal/Crystal for Flower Center

#7-D, Gold Pink/Opal/Crystal Base for Flower Petals

#WO-29, Dark Selenium Red/Opal/Crystal for Holly Berries

#BLACK, Dense Black for Head

Other Materials Required

Flux Solder 3/16" Copper Foil

18-Gauge Pretinned Copper Wire

Black Patina

Step 1

Make two copies of the pattern, number the pieces, and mark the desired grain direction on the copies. Using pattern shears for copper foil, cut apart one copy to use as a pattern for cutting the glass pieces. Use the other copy as a layout pattern while constructing your project.

Step 2

Cut the glass according to the pattern by holding the glass cutter upright between the first and middle fingers, with the first finger in front of the cutter and the thumb positioned behind the cutter. Score relief cuts when necessary. Use grozier pliers up to but not over the score line to remove excess glass. A glass grinder will help to smooth the rough edges on the glass and will shape the glass pieces to match the pattern.

Step 3

Wrap the glass with copper foil. Depending on your personal preference, you can use 3/16" or 7/32" copper foil for this project. We used 3/6" copper foil.

Step 4

Burnish the copper foil. This smoothes the edges of the foil. Hold the pieces in place on your layout pattern with pushpins.

Step 5

Using a flux brush, apply flux to the copper foil lines. The flux etches and cleans the copper so that it will accept the solder.

Step 6

Run a smooth, finished bead of solder along all of the copper foil lines. Slowly pull your iron along the lines while feeding the solder into the iron. Adjust the amount of solder according to the finished bead of solder.

Step 7

For the outer edge, a decorative lead U-channel or a copper wire can be soldered around the edge for reinforcement. We used 18-gauge pretinned copper wire. This same wire can be used to add details to the bird and leaves and to make hooks for hanging the suncatchers. A drop of solder is used for the bird's eye.

Step 8

Clean the project thoroughly with glass cleaner and 0000 steel wool. Apply black patina to darken the solder lines. A little bit of water on your project when applying the patina will prevent the patina from staining your glass. Clean the project again after applying the patina and apply a glass wax. This will help to keep the finished piece from oxidizing.

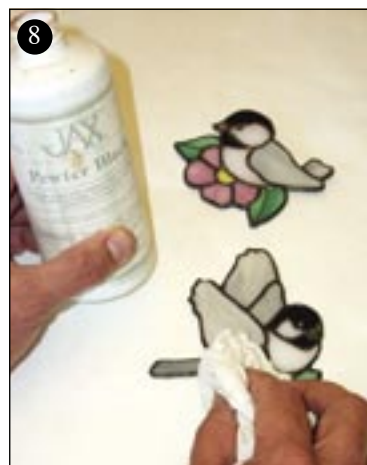
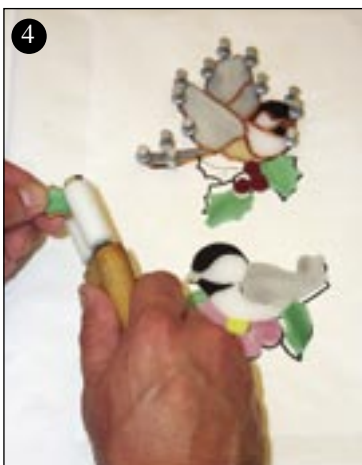
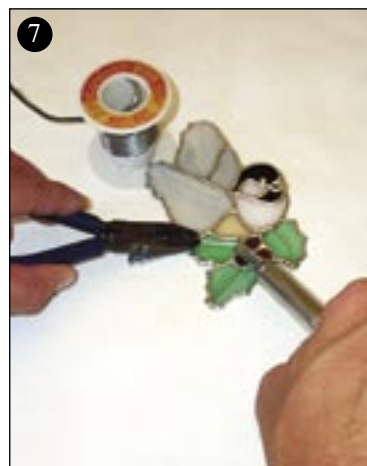
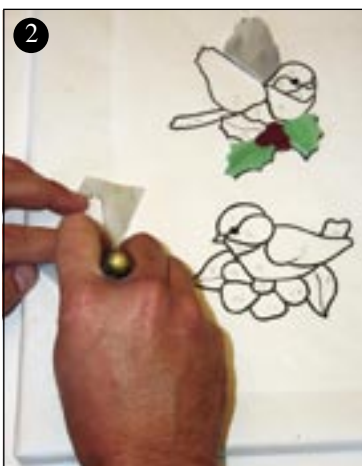
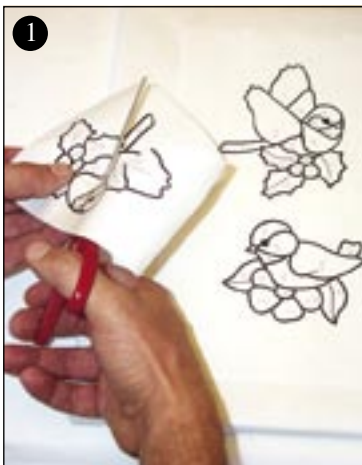

Compliments of:

GLASS PATTERNS
— Q U A R T E R L Y —

www.GlassPatterns.com

Stylized Chickadees

Design by Casey Koller

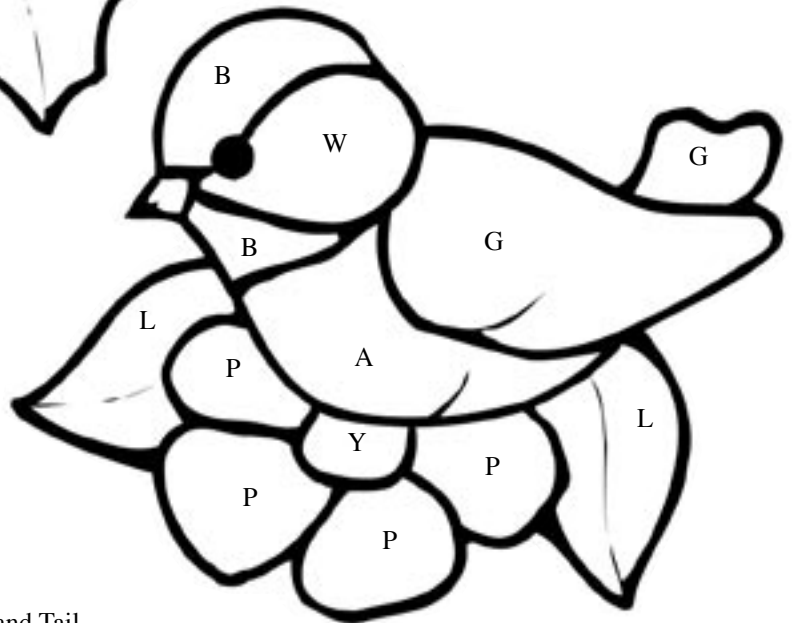
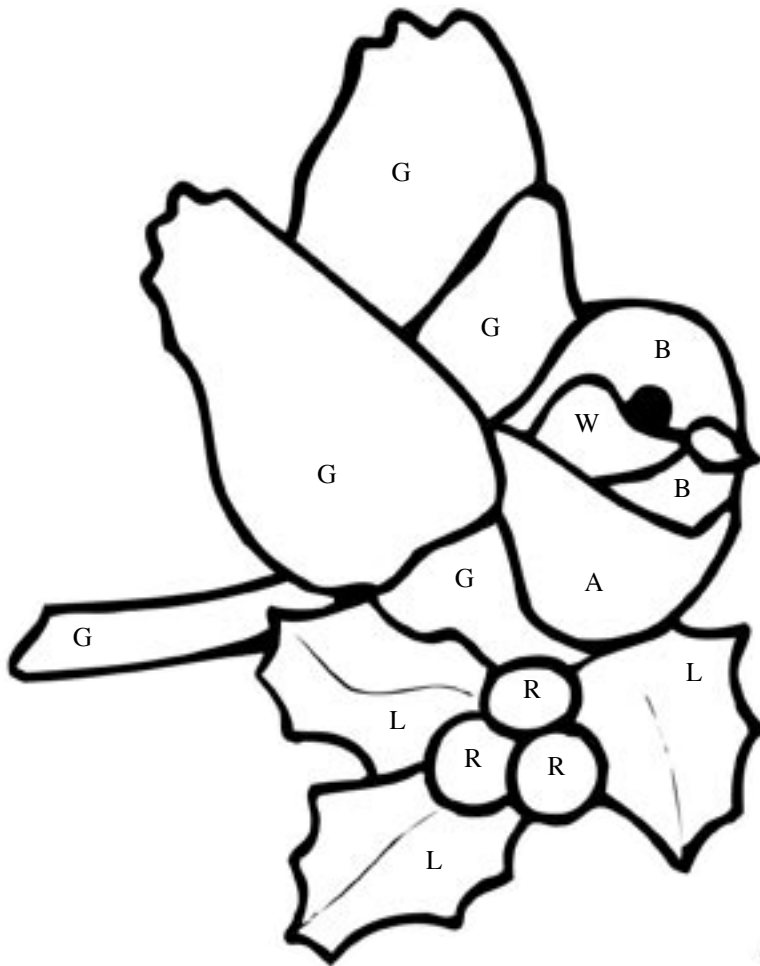

G - Opal Swirled with Medium Gray/Brown for Wings and Tail

W - Opal Swirled with Crystal for Face and Neck

A - Medium Amber/Opal/Crystal for Breast

L - Medium Green/Opal/Crystal for Leaves

Y - Yellow/Opal/Crystal for Flower Center

P - Gold Pink/Opal/Crystal Base for Flower Petals

R - Dark Selenium Red/Opal/Crystal for Holly Berries

B - Dense Black for Head

All pieces cut from scrap glass