



Mosaic Picture Frame

Design, Fabrication and Text by Dave Burnett

MosaicArt™ Venetian Glass Tiles

#MS 121, 3/8" Light Blue, #MS 122, 3/8" Royal Blue

#MS 139, 3/4" Dark Blue, #MS 141, 3/4" Emerald

Other Materials Required

MosaicArt™ 6" x 8" Reusable Frame Mold

MosaicArt™ 4-1/2" x 6" Picture Frame Back

MosaicArt™ MosaicStone™ Cement

MosaicArt™ Wheeled Glass Nippers

Venture Tape® Mosaic Mount™

Petroleum Jelly Epoxy Glue

1. Cut a sheet of Mosaic Mount™ that covers the size of the picture frame design. Tape the Mosaic Mount™ to the back of the layout design. Cut the design and the Mosaic Mount™ on the pattern outline, and cut the inside opening so that the finished size fits inside the mold.

Place the glass pieces on the pattern with the desired side facing up. Arrange the pieces so there is at least 1/8" between each glass piece.

2. The triangles are formed using the wheeled glass nippers and cutting the squares in half diagonally.

3. The circles are formed by nipping small pieces of the squares away, rounding the edges. Continue cutting and placing the pieces on the layout design.

4. Peel the back off of the Mosaic Mount™ and press the sheet over the glass pieces, sticky side down. Be careful that the Mosaic Mount™ does not stick to the pattern paper.

Prepare the mold by lightly coating the inside edges of the frame with petroleum jelly. This will allow the cement to release from the mold when dry.

5. Turn the Mosaic Mount™ over and place in the mold with the glass pieces facing up. Check the glass pieces for the final fit. Then, press the glass down firmly. This will keep the pieces from shifting when pouring the MosaicStone™ Cement.

Mix 1-1/4 cups of cement with 3 ounces of water. When mixed, the cement should be the consistency of pancake batter. Leave 1 tablespoon of cement off to the side for later use if needed.

6. Pour the mixture into the mold. Fill approximately 7/8 full. Tap the work surface under the mold for 1 to 2 minutes to release any air bubbles.

The cement dries within one hour. Do not allow the cement to set in the mold once it has hardened, or clean up may be difficult. When the cement has hardened, turn the mold upside down and release the frame.

7. Peel the Mosaic Mount™ off of the frame. Clean any excess cement off the glass with a wet scrub sponge. Any air bubbles in the cement can be filled in with a small amount of the cement that was set aside earlier. Mix the cement with water and rub it into the holes with a circular motion. Allow the frame to dry for 36 hours.

8. Squeeze epoxy glue on the frame back. Open the door of the frame back to keep from gluing it shut. Align the frame back to the frame and press together. Let dry 24 hours before using.

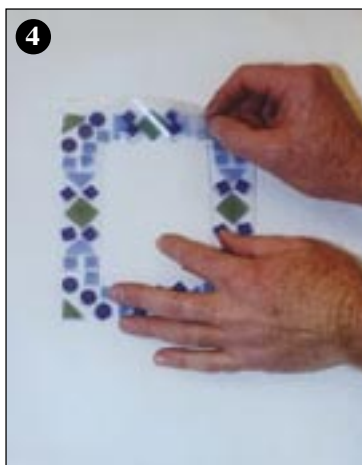
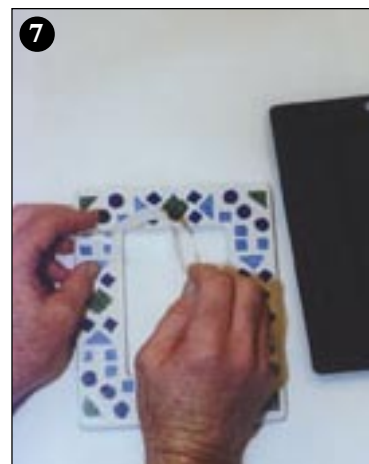
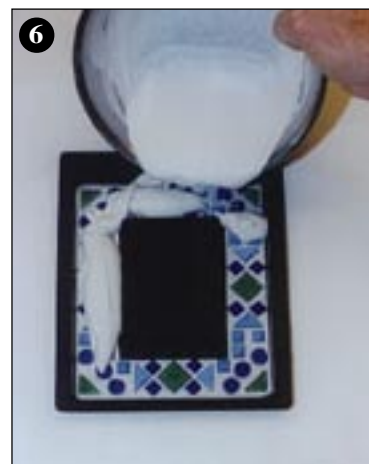
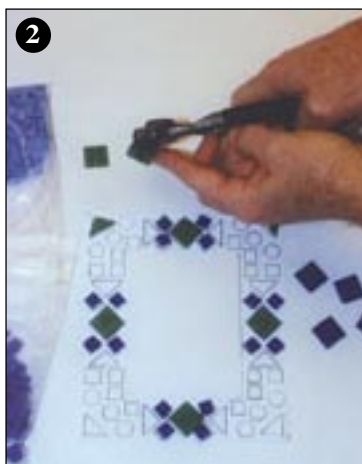

Mosaic Picture Frame

Design by Dave Burnett

E - Emerald
L - Light Blue
R - Royal Blue
D - Dark Blue

